

# Pop Up Stands

## User set up instructions

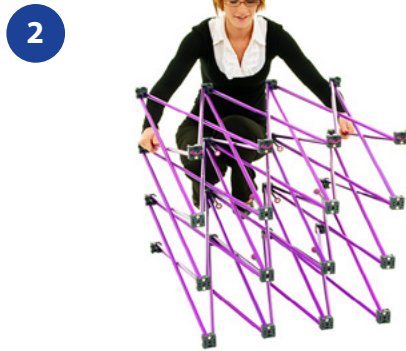

Pop Up Display Stands kit includes: aluminium frame, magnetic bars, printed graphic panels, graphic wrap panel, spotlights and transport case. Kit contents vary dependent on stand size.



Take the Pop Up frame and hold either end as shown. With a throw action, open out the frame.

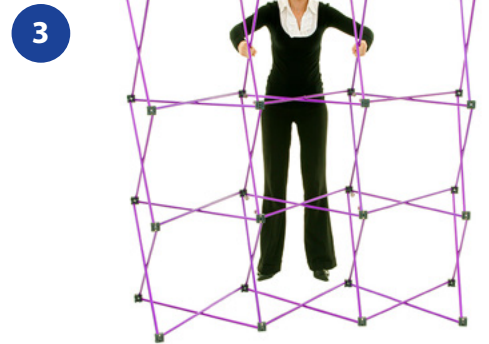

Pull open the frame until the frame clicks into place.

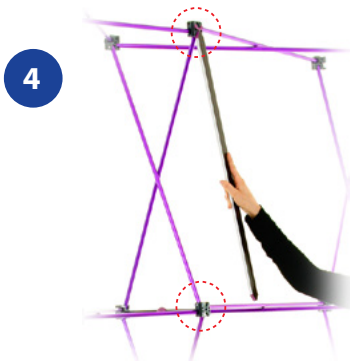

Build the Pop Up frame by placing the magnetic bars into the magnetised node slots as shown.

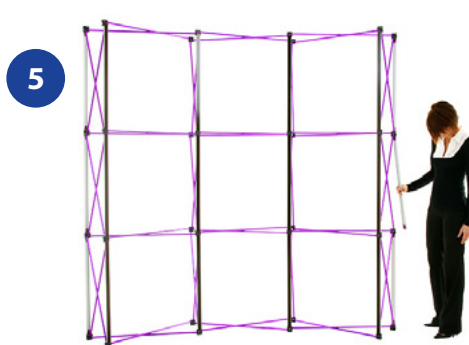

Ensure all magnetic bars are fitted in position, including rear bars on the reverse side as shown.



Carefully unroll each graphic panel and hook the the top of each panel onto the retaining hooks at the top of the frame.



Hang the graphic panels, starting at one end and secure each panel along the top, lining up the graphics as you go along.



Ensure the graphics line up with the magnetic strips running vertically down each section of the frame. Re-position panels as needed for perfect alignment.



The Pop Up Display Stand is now ready for your exhibition!